

# Identification guide

## Order code (example)

**CX - 176 - LFS1 - 200 - 50 - \*\*\***

Individual number of drawing or special version

Nominal shore hardness of the rubber element

0 – without fall-safe device  
1 – with fall-safe device

0 – long outside hub  
5 or 6 – short inside hub

Hub version

Basic design:

L	= series with link coupling, or
G+N	= series with membrane
B	= series with pin and bush
F	= flywheel flange on one side
S	= hub for shaft on one side
1	= quantity of rows of rubber elements

The first digit indicates the series of rubber element  
0 = traditional series of ring elements with 2 digits for sizes 50–90  
1 = new series of ring elements, sizes 176–188  
2 = new series of segmented elements, sizes 276–288  
3 = new series of segmented elements, sizes 391–394  
4 = new series of segmented elements, sizes 490–498  
Second and third digit stand for size of the rubber element

CENTAX® = product name

# Required information when requesting a quote

By providing the serial number, correct identification of the coupling / spare parts is possible and a new Class Certificate can be issued.

The serial no is hard-stamped on the hub, no. dismounting is required.

1. Imo number/vessel name
2. Coupling model (example: CX-75-GFS2-3A0-62495)
3. Class society
4. Serial Number (hard stamped on hub)

Serial 237/02 and 1774/06



## CENTA Coupling types

CENTAX O-100 – Series of ring elements  
Available in sizes from 00 to 192

GSS1; GSF1; LFS1 Coupling with 1 row of the rubber element  
GSS2; GSF2; LFS2 coupling with 2 rows of rubber element  
GSS3; GSF3; LFS3 coupling with 3 rows of the rubber element



1 row of rubber element



2 rows of rubber element

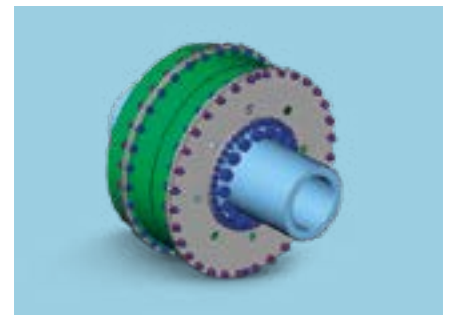

3 rows of rubber element

### Everllence

Everllence PrimeServ Omnicare Product Center  
Rivium Quadrant 75  
2909LC Capelle aan den IJssel  
The Netherlands  
primeserv-omnicare@everllence.com  
www.everllence.com/omnicare